

REVISIONS			
REV.	DESCRIPTION	DATE	DRAWN BY
A	MODIFIED MOTOR ORIENTATION	12/15/2010	PAL
B	CHANGED TO DOUBLE BEARING CONFIGURATION	4/25/2010	PAL

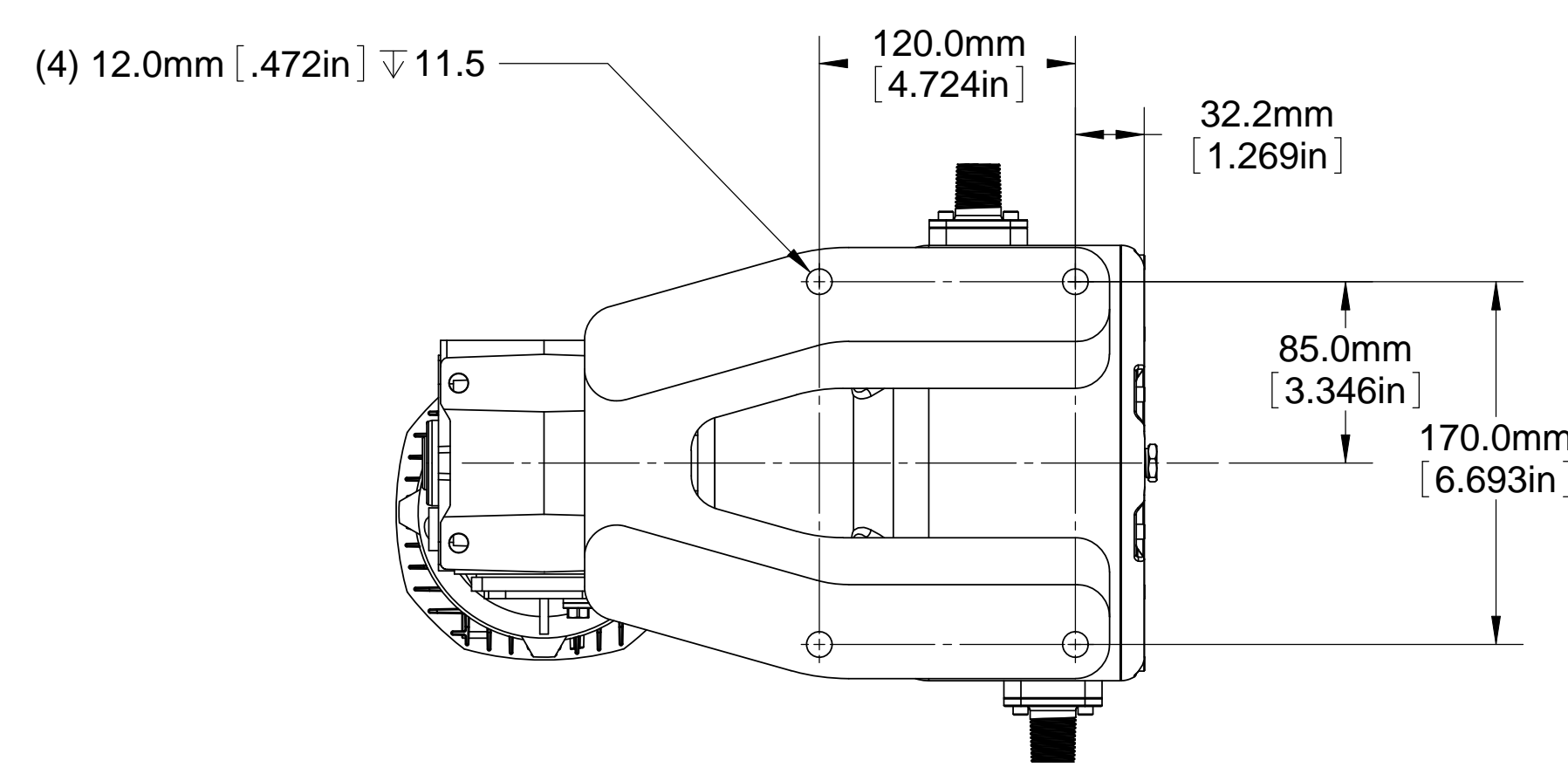
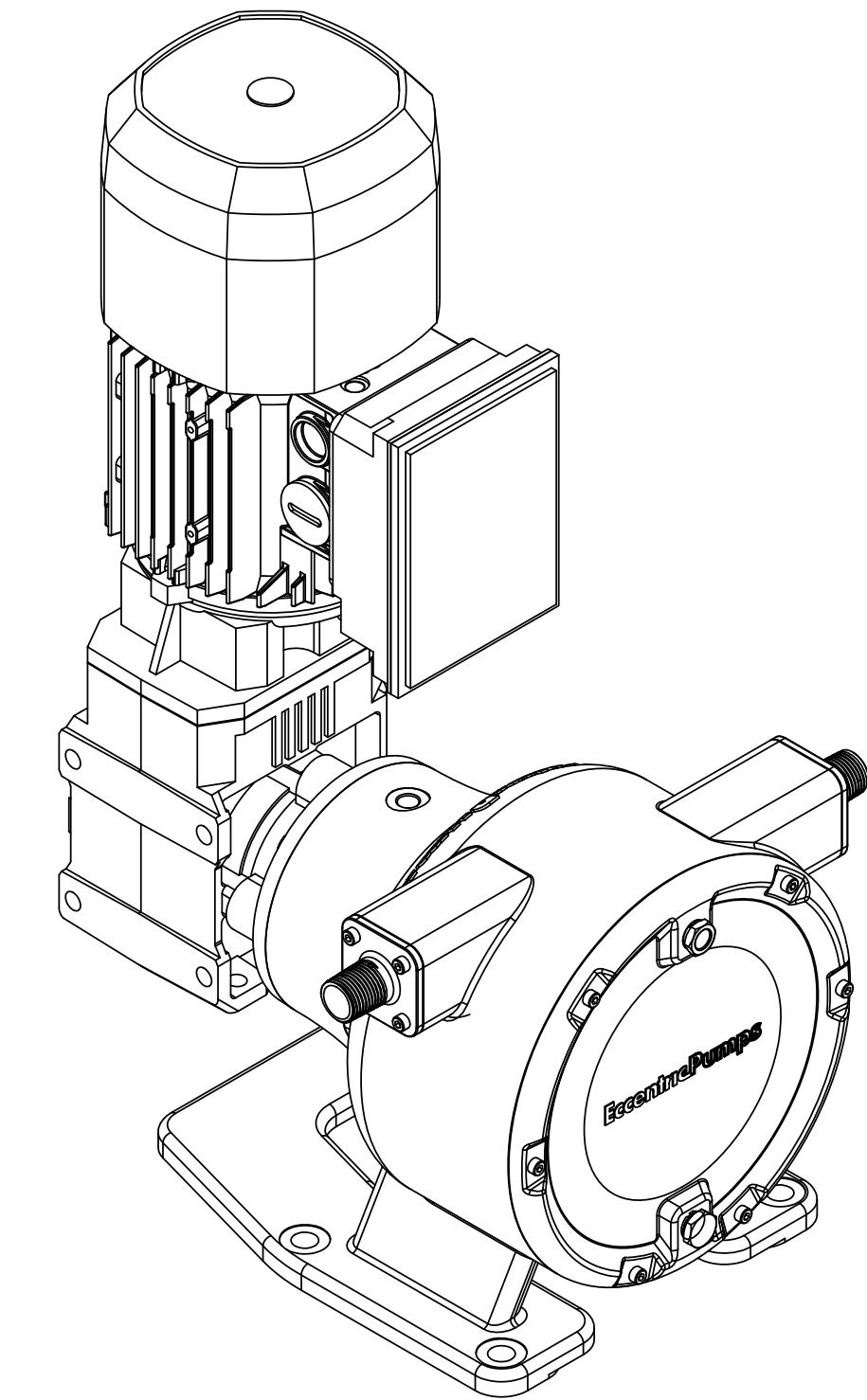
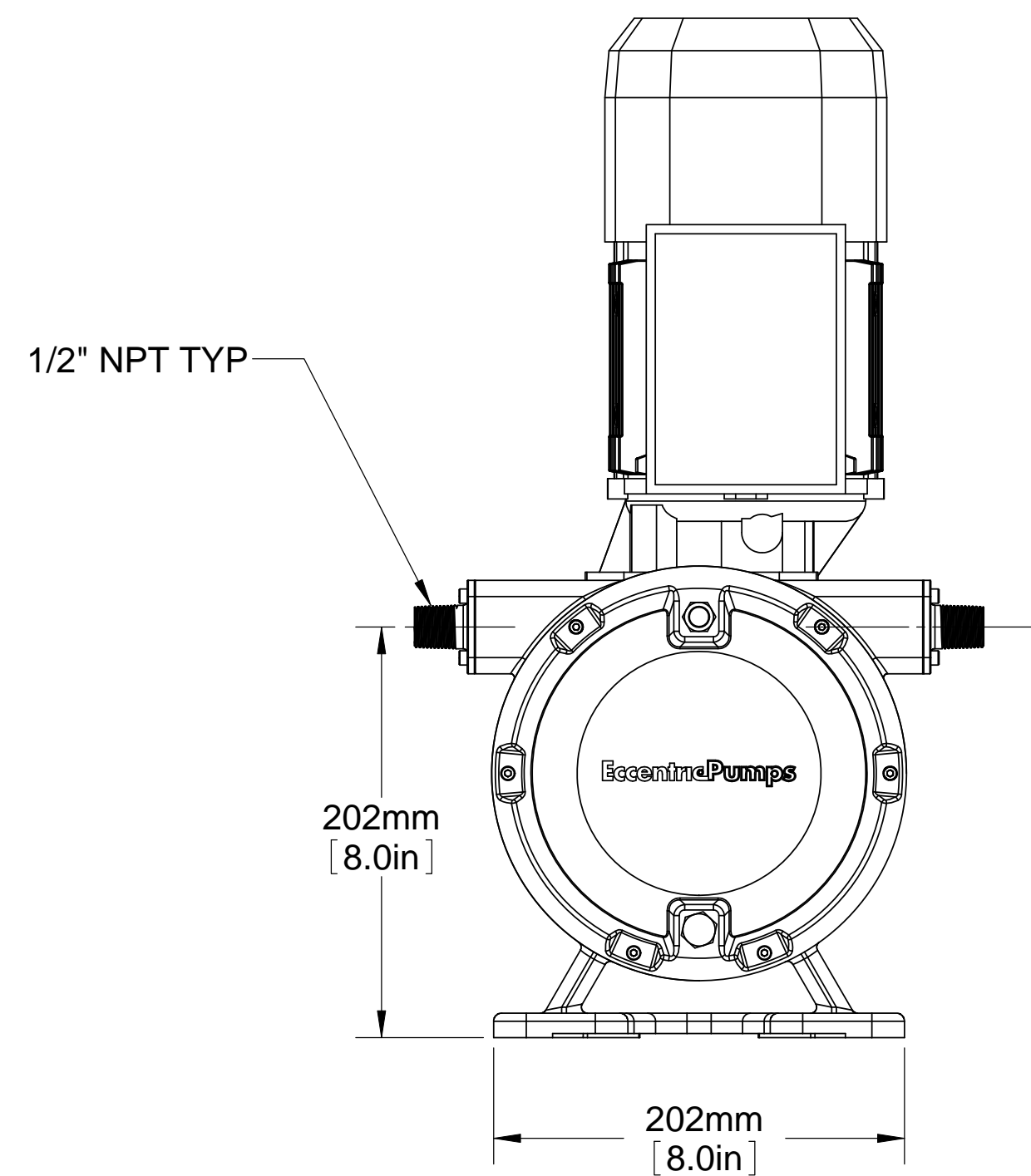
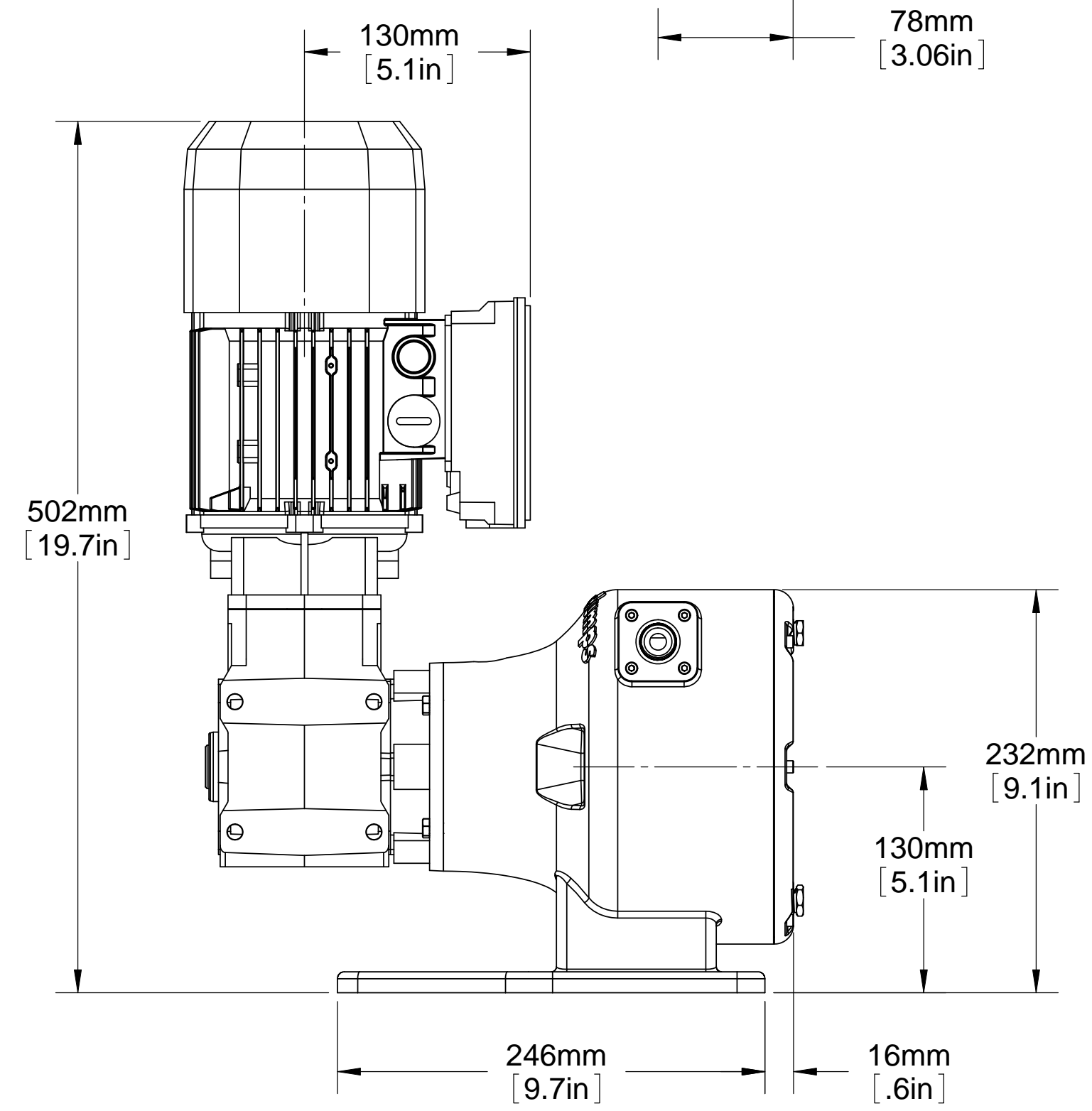
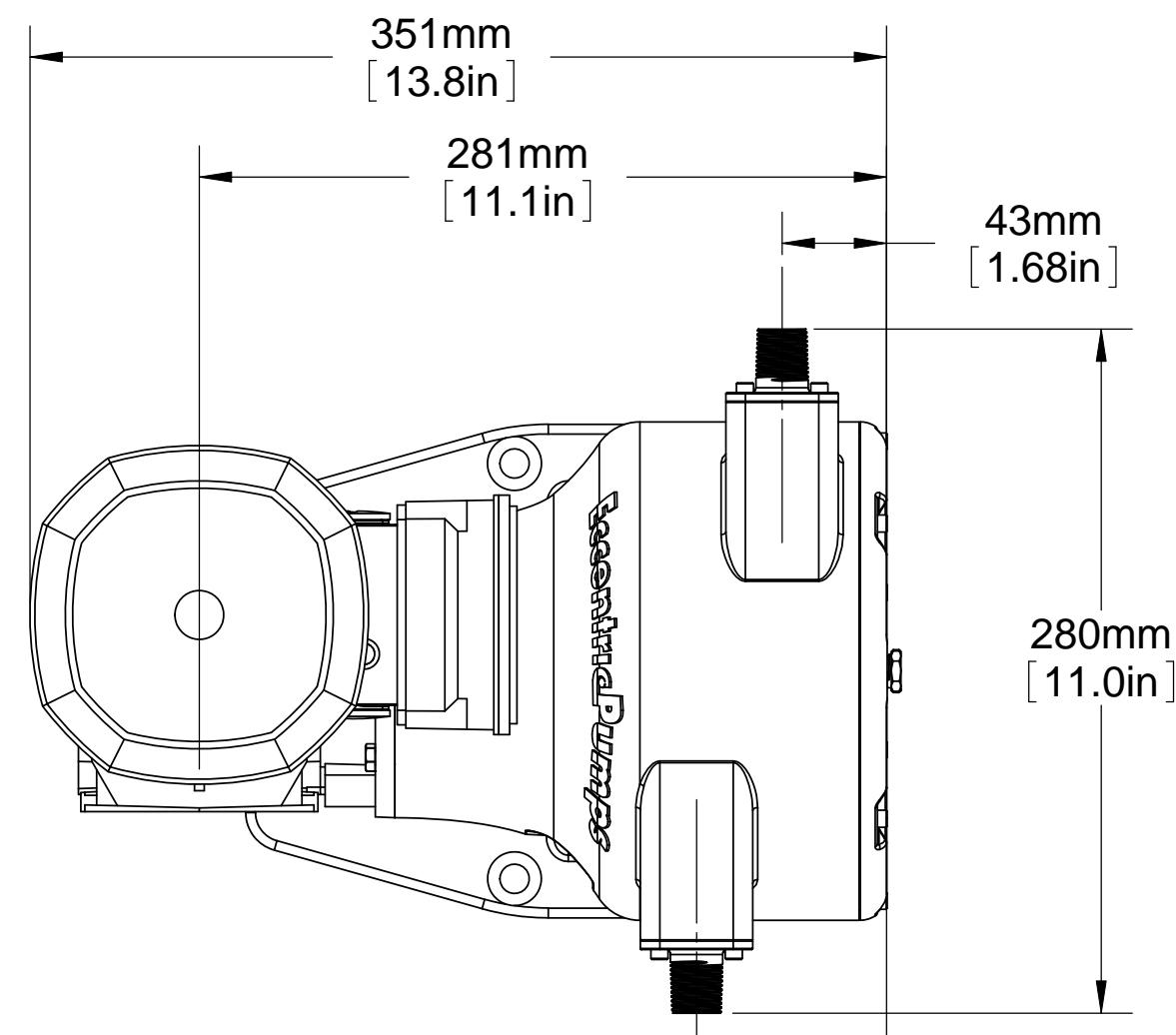

PROPRIETARY AND CONFIDENTIAL
 INFORMATION DISCLOSED HEREIN IS THE PROPERTY OF ECCENTRIC PUMPS. SAID INFORMATION IS FURNISHED FOR EVALUATION PURPOSES ONLY AND SHALL NOT BE USED OR DISCLOSED FOR ANY OTHER PURPOSE EXCEPT AS SPECIFIED BY CONTRACT BETWEEN THE RECIPIENT AND ECCENTRIC PUMPS. DUPLICATION OF ANY PORTION OF THIS DATA SHALL INCLUDE THIS LEGEND.

		UNLESS OTHERWISE SPECIFIED:	NAME	DATE
		DIMENSIONS ARE IN mm	PAL	8/9/2009
		TOLERANCES	DRAWN	
		ANGULAR: MACH ± 1/2	CHECKED	
		BEND ± 1/2	ENG APPR.	
		NO DECIMAL PLACES ± .50	MFG APPR.	
		ONE PLACE DECIMAL ± .10	Q.A.	
		TWO PLACE DECIMAL ± .05	COMMENTS:	
		INTERPRET GEOMETRIC TOLERANCING PER: ANSI Y14.5		
		MATERIAL		
		FINISH		
NEXT ASSY	USED ON	APPLICATION		
		DO NOT SCALE DRAWING		

EccentricPumps
 P.O. Box 190159
 Atlanta, GA 31119

TITLE: **MINIPUMP ASSEMBLY**

SIZE	DWG. NO.	REV
C	MP ASSEMBLY - DOUBLE BEARING	B

SCALE: 1:4 WEIGHT: SHEET 1 OF 3